



ACCURATE

LOCK & HARDWARE

AMERICAN CRAFTED SINCE 1972

G-CYL + GO-CYL SERIES

UNIVERSAL CYLINDRICAL LOCK PATCH FOR GLASS SWINGING DOORS



**G-CYL GLASS PATCH SHOWN WITH
SCHLAGE® ND SERIES**

Innovative Solutions for Glass Doors

G-CYL + GO-CYL SERIES

The G-CYL is a universal cylindrical lock patch for glass swinging doors. Designed to house any commercial cylindrical lock to work with wall partition systems with frameless openings. The G-CYL and GO-CYL Patch Kits are one solid piece that houses the cylindrical lock to provide a contemporary and sleek solution for centered and offset swinging glass door applications.



G-CYL + GO-CYL Series

UNIVERSAL CYLINDRICAL LOCK PATCH KIT

- Available centered on glass (G-CYL) or offset on glass (GO-CYL)
- Designed for glass wall partition systems with frameless openings
- Standard set up is for a 2 ³/₄" backset lockset on 1 ¹/₂" thick tempered glass
- Note: Cylindrical locks to be supplied by others and can be installed onsite once G-CYL/GO-CYL patch is installed.



G-CYL PATCH KIT WITH G-CYL-P STRIKE

G-CYL Centered on Glass Patch Dimensions

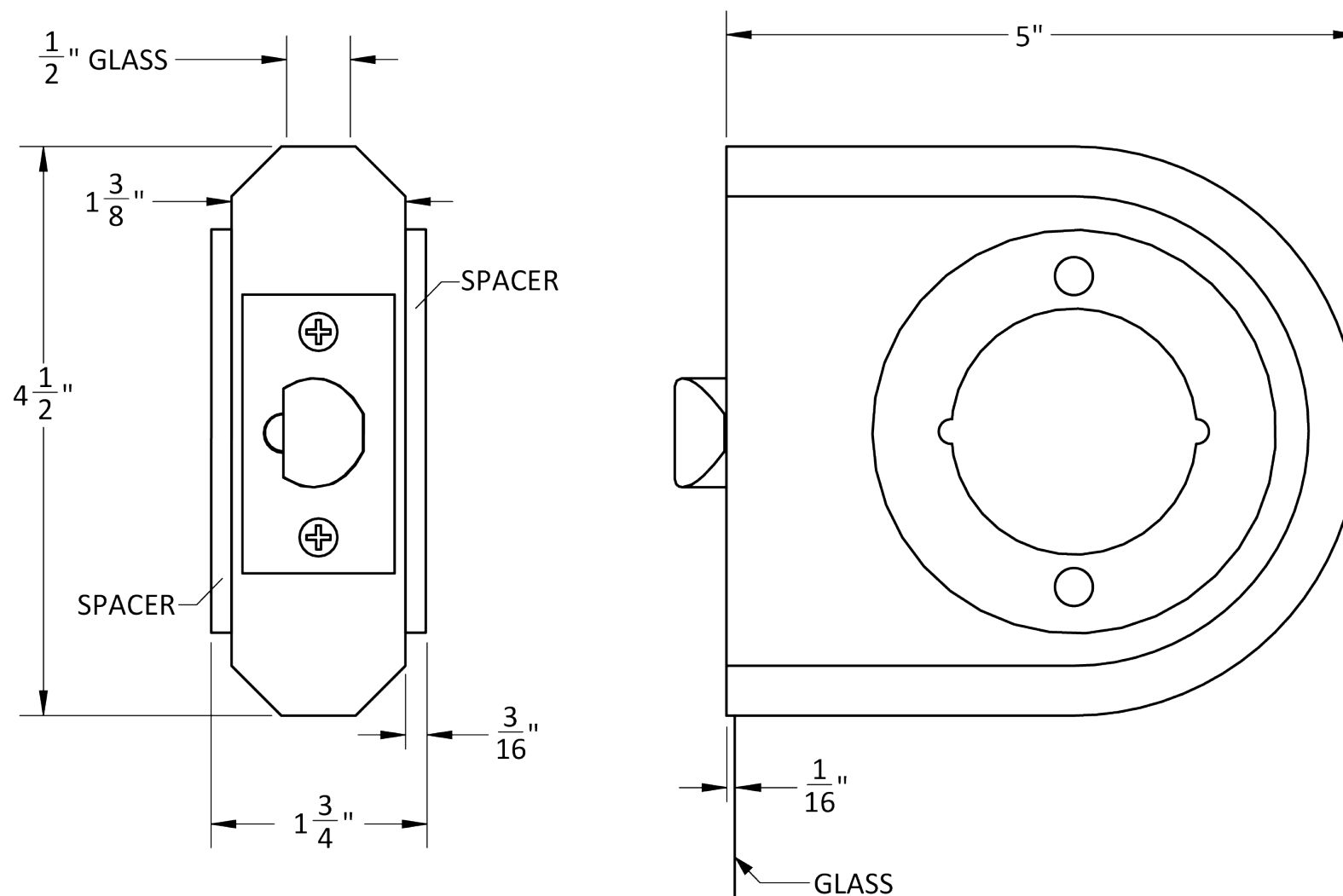

Standard through-bolting is vertical, can be modified for other configurations.

G-CYL GLASS PATCH

GO-CYL Offset on Glass Patch Dimensions

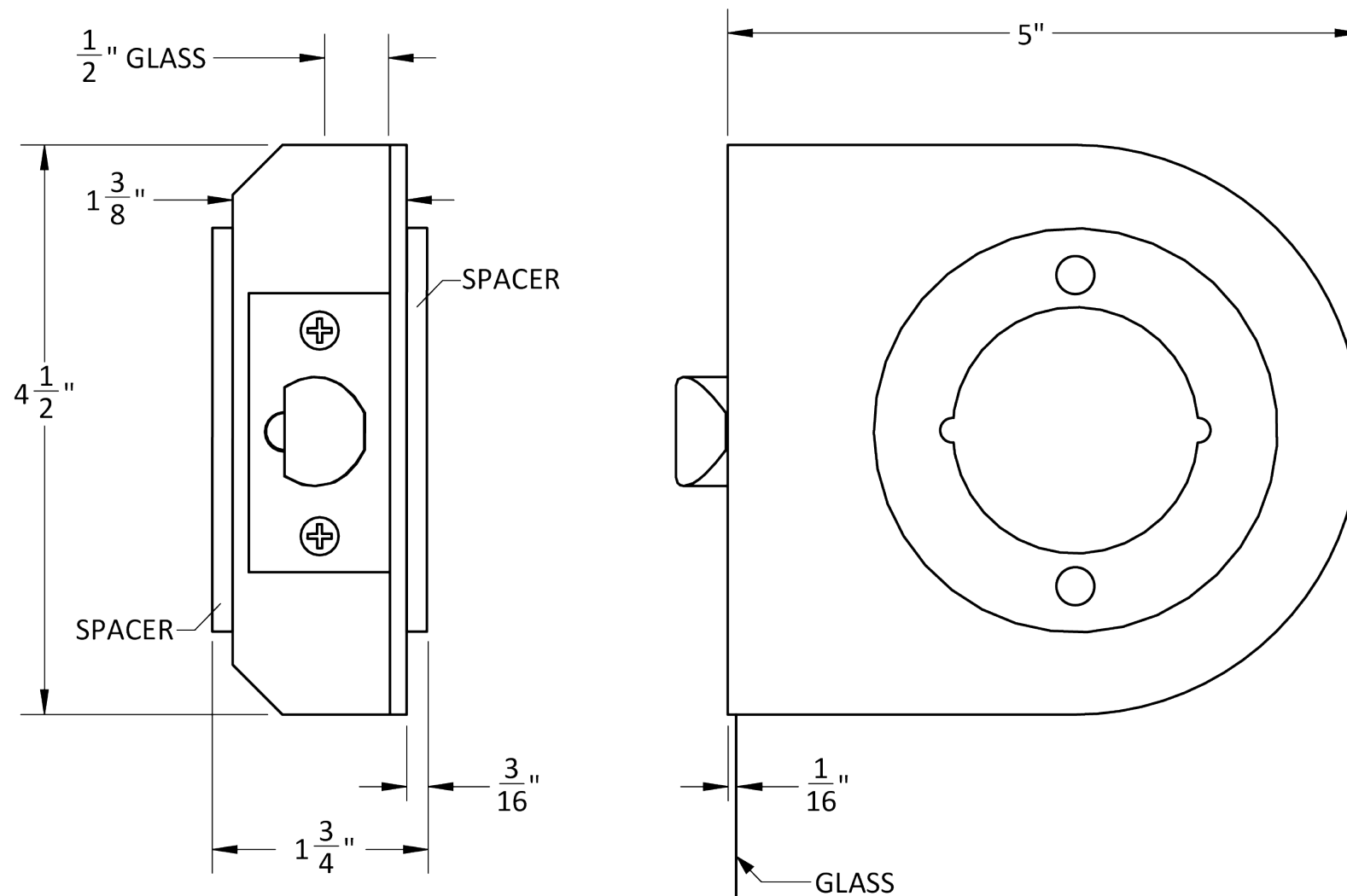

Standard through-bolting is vertical, can be modified for other configurations.

GO-CYL GLASS PATCH

G-CYL-P Centered on Glass Patch Strike

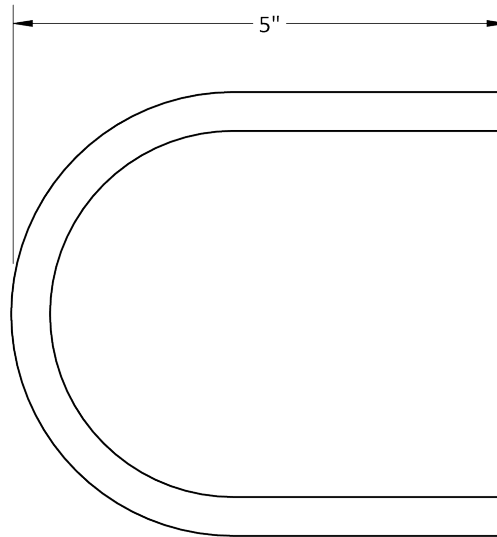

OUTSIDE VIEW

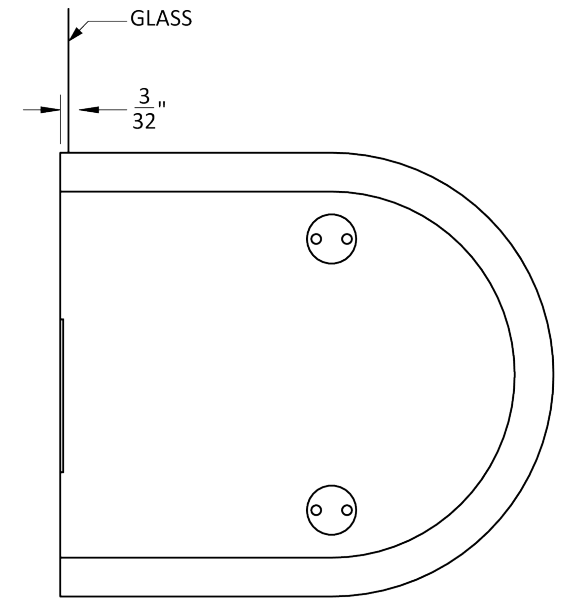
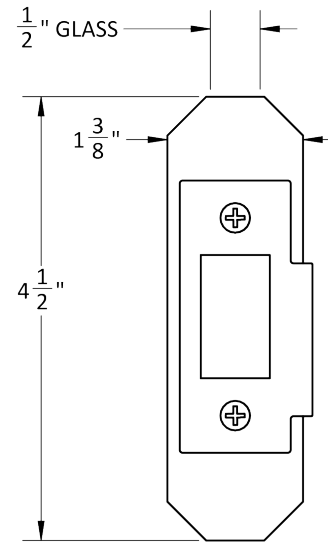

INSIDE VIEW

Specify G-CYL-P Glass Patch Strike kit.

G-CYL-PE Electrified Centered on Glass Patch Strike

G-CYL-PE



G-CYL-PES

AVAILABLE WITH INTEGRATED STOP

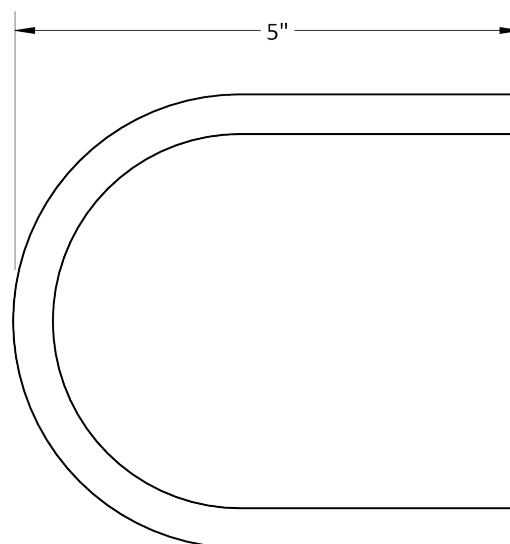

OUTSIDE VIEW

REQUIRES METAL CHANNEL
FOR WIRING INTO CEILING
OR FLOOR

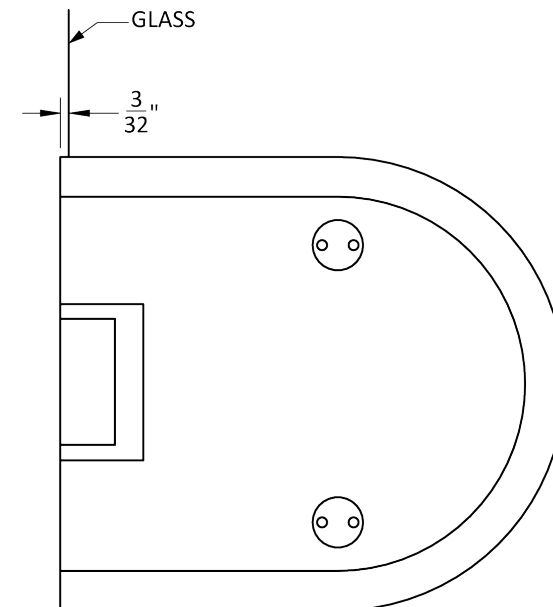
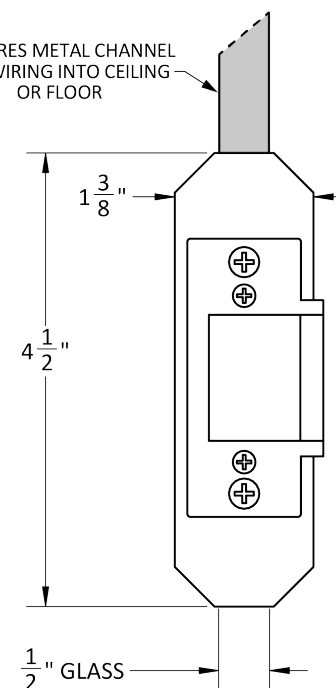

INSIDE VIEW

When specified, G-CYL-PE and G-CYL-PES Glass Patch Strike kits are furnished to allow specific electrified strike installation on site. Electrified strike by others.

**G-CYL-PE ELECTRIFIED GLASS
PATCH STRIKE**

G-CYL-PE Glass Prep Template

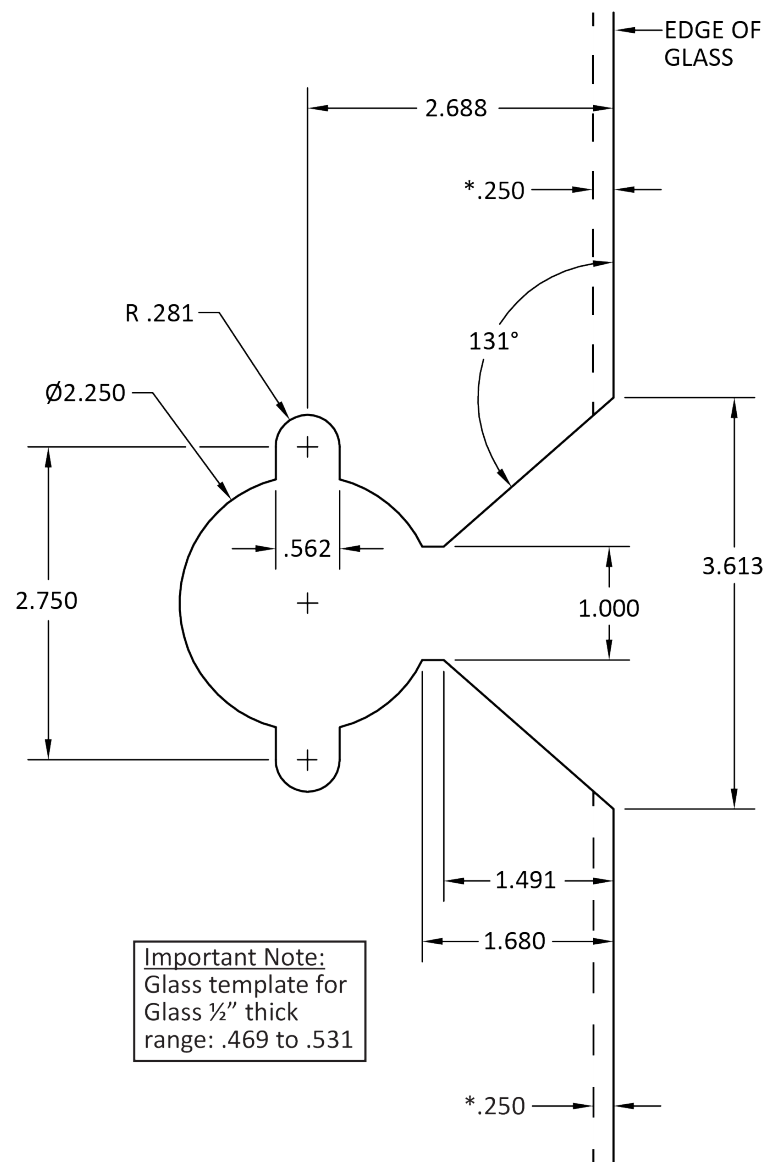

*.250 CUT FOR METAL CHANNEL.
CHANNEL GOES EITHER UP INTO CEILING
OR DOWN INTO FLOOR

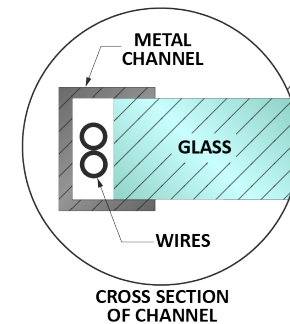
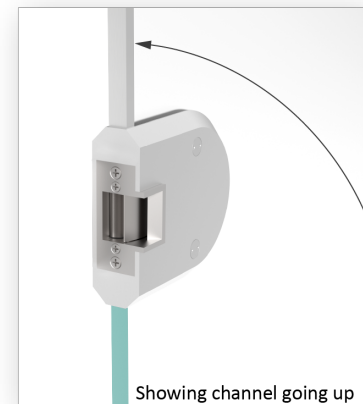

HOW TO SPECIFY

HANDING

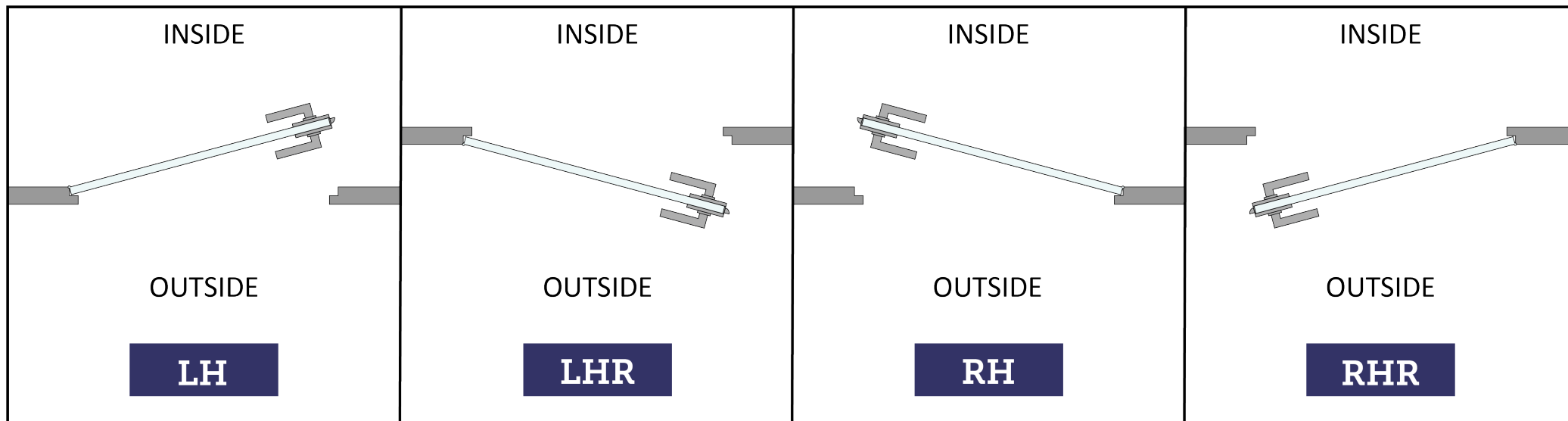

FINISHES

GROUP 1: US26D, ESN

GROUP 2: US4, US10B, US19, US26

Other finishes available, please [contact us](#) for assistance.

G-CYL | GO-CYL | HOW TO SPECIFY

MODEL.BACKSET.LOCKSERIES.FINISH.HAND.DOORTHICKNESS.STRIKEOPTIONS

Model
G-CYL
GO-CYL

Backset
Standard 2³/₄"
Backset

Lock Series
Manufacturer's
Lock Series

Finishes
See available
finishes pg. 10

Door Thickness
Standard ½" glass
door

Strike Options
G-CYL-P
G-CYL-PE

EXAMPLES

Glass Patch Kit | Centered | To Accept Schlage® ND Series | Matching Patch Strike

E.g. G-CYL.234.SCHLAGE-ND.US26D.RH.1/2.G-CYL-P

Glass Patch Kit | Centered | To Accept Corbin Russwin CL3000 Series | Electrified Patch Strike

E.g. G-CYL.234.CL3000.US4.LH.1/2.G-CYL-PE

Glass Patch Kit | Offset | To Accept Schlage ND Series

E.g. GO-CYL.234.SCHLAGE-ND.US10B.LH.1/2

NOTES

- Cylindrical Locks to be supplied by others and can be installed onsite once G-CYL/GO-CYL patch is installed.
- When specified, G-CYL-PE/G-CYL-PES Glass Patch Strike kits are furnished to allow specific electrified strike installation on site. Electrified strike sold by others.

**ACCURATE LOCK & HARDWARE
MANUFACTURERS OF LOCKS AND
CUSTOM ARCHITECTURAL HARDWARE**

1 Annie Place | Stamford, CT 06902

P: 203.348.8865

F: 203.348.5234

E: sales@accuratelockandhardware.com

www.accuratelockandhardware.com

**AMERICAN CRAFTED
— SINCE 1972 —**